

VANTAGE 101
101 LBS THRUST
36VOLT 46 AMPS

for use with "AI" serial numbers
2-year warranty from the date of purchase

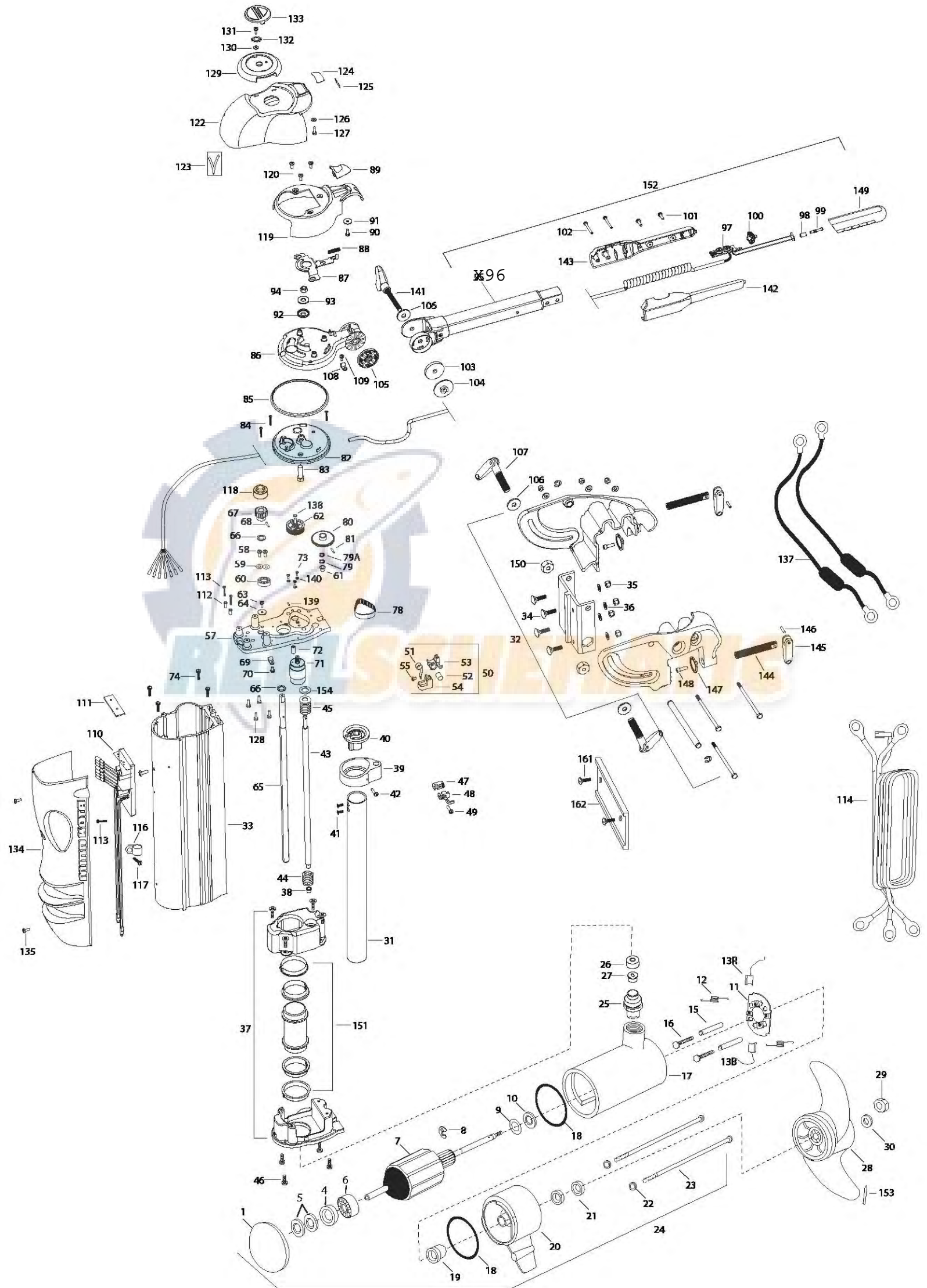

1	421-276	PLAIN END HOUSING ASSEMBLY		*75	2051927	TOP PLATE, VANTAGE		*106	2051737	WASHER-FLAT,ID.406 X OD.8
4	990-045	THRUST SPACER		58	2053414	SCREW-#8-32 X 1/2 TRI-LOBE[2.EA]		*107	2050922	HANDLE, TENSION, SHORT
5	992-010	SPRING WASHER [2.EA]		59	2051717	WASHER-#8 SAE FLAT ZNK PLT [2.EA]		108	2052510	CABLE CLAMP, 3/16" VANTAGE [2.EA]
6	140-010	BALL BEARING		*60	2057306	BEARING-BALL (VANTAGE)		109	2053415	SCREW-#8-32 X 3/8" TRI-LB[3.EA]
7	2-100-216	ARMATURE ASSEMBLY		*61	2057302	BEARING-UPPER, LIFT SCREW		*110	2774041	CNTRL BRD ASSY 24/36V W/PAD INCL.111
8	788-040	RETAINING RING		*62	2052630	PIN, CLUSTER GEAR		*111	2315105	INSULATING PAD
9	990-051	WASHER-THRUST, STEEL		63	2053415	SCREW-#8-32 X 3/8 TRI-LOBE P		112	2261712	SHOULDER WASHER [2.EA]
10	990-052	WASHER- NYLATRON		64	2051716	WASHER-FENDER #10		113	2053407	SCREW-#8-32 X .75 PPH[3.EA]
■	2-600-144	BRUSH/WIRE/PLATE ASSEMBLY INCL.11-13		65	2052001	SHAFT-STEERING, VANTAGE		114	2051220	LEADWIRE,24/36V,3 CONDUCT
*11	738-004	BRUSH PLATE 4" TERMINAL		66	2051706	WASHER-SPRING SUPPORT[2.EA]		116	2052512	CABLE CLAMP, 1/2" VANTAGE
*12	975-041	SPRING -TORSION [2.EA]		67	2052205	GEAR, STEERING TUBE MACHINED		117	2053415	SCREW-#8-32 X 3/8" TRI-LOBE P
13	188-094	BRUSH		*68	2052615	PIN-DRIV-LOK 1/8 X 1 1/8		118	2052210	ROLLER-STEERING SHAFT
13	188-094	BRUSH		69	2052510	CABLE CLAMP, 3/16" VANTAGE		■	2880102	CONTROL HEAD COVER LATCH KIT
15	973-025	SPACER -BRUSH PLATE [2.EA]		70	2053415	SCREW-#8-32 X 3/8 TRI-LOBE P				INCL. 89,90,91,119
16	830-027	SCREW -SELF THREADED 10-32 X 2" [2.EA]		71	2777812	MOTOR-LIFT (12,24,36V)		119	2050200	COVER-CONTROL HEAD
17	431-110	HOUSING ASSEMBLY- CENTER		72	2058410	TENSIONER-BELT (VANTAGE)		120	2053415	SCREW-#8-32 X 3/8" TRI-LOBE[3.EA]
18	701-043	O-RING (2 REQ'D)		73	2053422	SCREW - 3MM		121	2012100	SCREW-8-18 X 5/8" THD CUT[3.EA]
19	144-017	BEARING -FLANGE (SERVICE ONLY)		74	2053413	SCREW-10-16X1' TYPE AB,HEX[4.EA]		122	2050211	SHROUD-CONTROL HEAD
20	2-300-160	BRUSH END HOUSING ASSEMBLY		■	2882201	CLUSTER GEAR / FLANGE PULLEY KIT		123	2055612	DECAL-SHROUD (VANTAGE)[2.EA]
21	880-025	SEAL [2.EA]				INCL. 75,76,77		124	2055602	DECAL-COVER, 36V
22	701-009	O-RING -THRU BOLT [2.EA]		*75	2770428	PULLEY/PINION GEAR ASSEMBLY		125	2055610	DECAL-COVER, LED
23	830-096	THRU BOLT 12-24 X 11.56" SS [2.EA]		*76	2058405	FLANGE-PULLEY (VANTAGE)		126	2051712	WASHER- .152 ID, .50 OD, .06
24	2316261	MOTOR ASSEMBLY, 4", 36V (ITEMS 1-27)		*77	2053418	SCREW 4-40 X 1/4 PPH[2.EA]		127	2302100	SCREW-6-20 X 1/2" THD CUT
25	979-015	STRAIN RELIEF - BODY		78	2050800	BELT-DRIVE (VANTAGE)		128	2012100	SCREW-8-18 X 5/8" THD CUT(4REQ'D)
26	9950339	CAP - STRAIN RELIEF		79	2051705	WASHER-NYLON ID.312 X OD.		129	2050110	KNOB-POINTER, VANTAGE
27	2382900	GROMMET- STRAIN RELIEF		79A	2051703	WASHER-THRUST ID.315, OD.562		130	2051717	WASHER- #8 SAE FLAT ZNK PLT
28	2331160	PROPELLER (W.WEDGE 2) MAX 101		■	2882200	GEAR LIFT/PIN KIT INCL.80,62		131	2332101	SCREW-8-32 X 1/2" SS
29	2093101	NUT-PROP NYLOC (LARGE) MAX 101		*80	2990426	LIFT GEAR ASSEMBLY		132	2371715	LOCKWASHER-STAR #8 ZINC
30	2091701	WASHER-PROP (LARGE) MAX 101		81	2052620	PIN-DRIV-LOK 1/8 X 5/8"		133	2056700	PLUG, POINTER, VANTAGE
31	2772010	TUBE-MOTOR, 1 3/4" KIT W/TEMPLATE		82	2056520	CAP-LOWER, GEAR HOUSING		134	2050220	SHIELD-EXTRUSION, VANTAGE
32	2991822	TRANSOM BRACKET ASSEMBLY 36V		83	2383500	BOLT-3/8-16 X 1.25		135	2053414	SCREW-#8-32 X 1/2" TRI-LOBE[2.EA]
33	2056505	HOUSING EXTRUSION		84	2053402	SCREW-10-24 X 1" TRI-LOBE [3.EA]		136	2055611	DECAL-SHIELD (VANTAGE)[3.EA]
34	2053511	BOLT-CARRIAGE 5/16-18 1"[4.EA]		85	2054600	O-RING, GEAR HOUSING		137	2998200	CIRCUIT BRKR ASSEMBLY 36V [2.EA]
35	2151726	WASHER-5/16 STD (S/S)[4.EA]		86	2056510	CAP-UPPER, GEAR HOUSING		138	2051732	WASHER .315 X .562
36	2053103	NUT, 5/16-18 NYLOC [4.EA]		87	2057200	LATCH (VANTAGE)		139	2053420	SET SCREW #8-32
37	2770420	LOWER SUPPORT CAGE ASSEMBLY		88	2052711	SPRING, LATCH RETURN		140	2051710	LOCKWASHER 3MM
38	2057302	BEARING-UPPER, LIFT SCREW		89	2050102	KNOB-LATCH (VANTAGE)		141	2050921	HANDLE TENSION - LONG
■	2881510	YOKE/BEARING RACE KIT INCL.39,40,42		90	2353401	SCREW-10-16 X 1/2 STALGD		■	2880910	HANDLE L/R KIT
*39	2051510	YOKE-LIFT SCREW		91	2051716	WASHER-FENDER #10				INCL. 100,101,102,142,143,150
*40	2056200	BEARING RACE-YOKE		92	2151730	WASHER-CUP (HINGE BRACKET)		*142	2050916	HANDLE SIDE L
41	2053401	SCREW-10 X 1/2,TYPE 25,[2.EA]		93	2051737	WASHER-3/8 FLAT (ZINC)		*143	2050911	HANDLE SIDE R
42	2353401	SCREW-10-16 X 1/2 STALGD		94	2053107	NUT-3/8-16, TOPLOCK		144	2880925	HANDLE/CLAMP SCREW KIT
43	2053400	SCREW-LIFT, 1/2-10 ACME		96	2990921	HANDLE ASSEMBLY, VANTAGE		149	2880424	GRIP KIT
44	2052707	SPRING-COIL,SOFT STOP		■	2884106	HANDLE CTRL BOARD/GRIP KIT INCL. 97,149		*150	2053105	NUT- HEX
45	2770429	COIL SPRING/WASHER ASSEMBLY KIT		*97	2994005	CTRL BOARD ASSEMBLY-HANDLE		151	2881500	TUBE/SLEEVE/BUSHING KIT
46	2053413	SCREW-10-16X1' TYPE AB,HEX(4REQ'D)		98	2055115	BUTTON SWITCH ACTUATOR		152	2990950	HANDLE/CTRL BOARD ASSEMBLY
■	2883200	WIRE CLAMP KIT INCL. 47,48,49		■	2883701	PLUNGER/GRIP KIT INCL. 99,149		153	2262658	PROP PIN
*47	2053200	WIRE CLAMP, LEFTHAND		*99	2053700	PLUNGER, ON/OFF		154	2340610	CONNECTOR CABLE
*48	2053205	WIRE CLAMP, RIGHTHAND		100	2050111	KNOB-SPEED CONTROL				
*49	2053417	SCREW-10-16X3/4 TYPE BT,PPH		101	2012100	SCREW-8-18 X 5/8" THD CUT[2.EA]		160	2774840	TRANSOM EXTRUSION KIT INCL.161
50	2770400	TAPE SPRING ASSEMBLY INCL. 51-55		102	2053412	SCREW 8 X 1.5"TYPE 25 PPH[2.EA]		*161	2053419	BOLT 14-1/4X1
51	2052705	SPRING, CONSTANT FORCE		■	2880921	HANDLE TENSION KNOB KIT				
52	2052610	PIN-PIVOT 7/16" O.D.				INCL. 103,104,105,141				
53	2051920	BRACKET-SPRING		*103	2051736	WASHER-URETHN,ID.4 X OD 1				
54	2052305	WIRE GUIDE (VANTAGE)		*104	2053115	NUT-WASHER, HANDLE ASSEMBLY				
55	2053418	SCREW-#4-40X1/4 TYPE F,PPH		*105	2050015	RACHET-DISK, HANDLE ASSEMBLY				
56	2050225	WIRE SHIELD		■	2880920	BRACKET TENSION HANDLE KIT				
■	2770405	TOP PLATE ASSEMBLY INCL.57,60,61,68				INCL. 106,107,150				

2889460 seal & oring kit

VANTAGE 101

36 VOLTS ONLY

